

FAO the Occupant



Aptus Utilities

www.apтусutilities.co.uk

APTUS UTILITIES

Direct House

Lancaster Way

Wingates Business Park

Bolton BL5 3XY

T: 01204 325000

E: info@apтусutilities.co.uk

05.07.2017

Dear Sir / Madam,

Aptus Utilities have been appointed to undertake the utility works for Eccleston Homes Ltd on Preston Road, Grimsargh.

The works are to carry out gas, electric & water connections to site. These works are to take place between 24/07/2017 until 08/08/2017 in agreement with the council highways authority, providing that there are no engineering difficulties that arise.

Access will be maintained at all times to your properties however we may require vehicles to be moved, at some point. We will ask this of you, if it is required, nearer to the time.

The work will involve excavations, machinery and heavy vehicles at times, and will be working behind 2 and 3 way temporary traffic lights.

We apologise in advance for any inconvenience this work may cause and will endeavour to keep disruption to a minimum

If you have any questions or wish to discuss the matter further you can contact the office on 01204 325 000.

Regards

P.P.

Jimmy Fisher
Project Manager

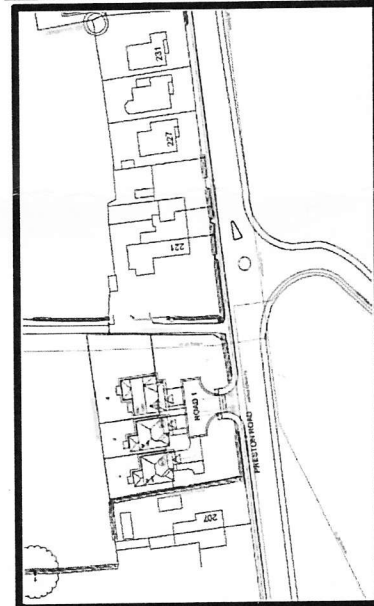
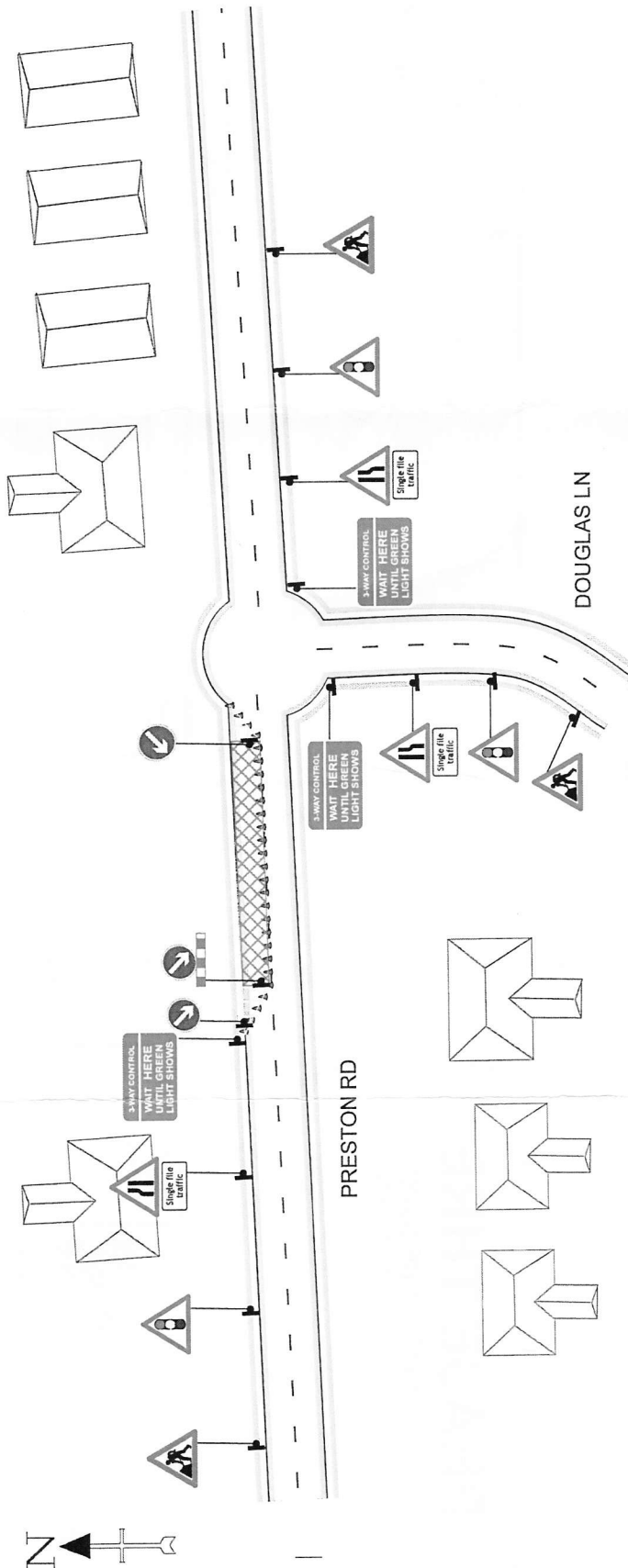

Key

- Sign Face
- Safety Zone
- ▣ Works Area

Signal Head	All Red	All Green
A	10 Sec	25 Sec
B	10 Sec	25 Sec
C	10 Sec	25 Sec

Please note that the setting of Maximum Green timer should be increased if substantial queues begin to form.

The timings should not be reduced below the initial settings approved.

Timings can be increased to suit traffic flow.

PHASE ONE

3 WAY LIGHTS TO BE MANNED
DAILY BETWEEN 0730 - 1800

	Client: Aptus Utilities Date: 05/07/2017 Not To Scale	Drawing Description: 3 Way Lights Job Location: Preston Road, Grimsaigh	Comments:	Drawing No:
	Spen Trading Estate, Spen Lane, Cleckheaton, West Yorkshire, BD19 4AB Tel: 0845 2221222	Spen Trading Estate, Spen Lane, Cleckheaton, West Yorkshire, BD19 4AB Tel: 0845 2221222	Drawn By: John Brierley Verified By: Philip Morris	

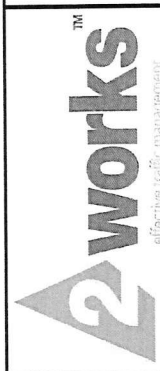

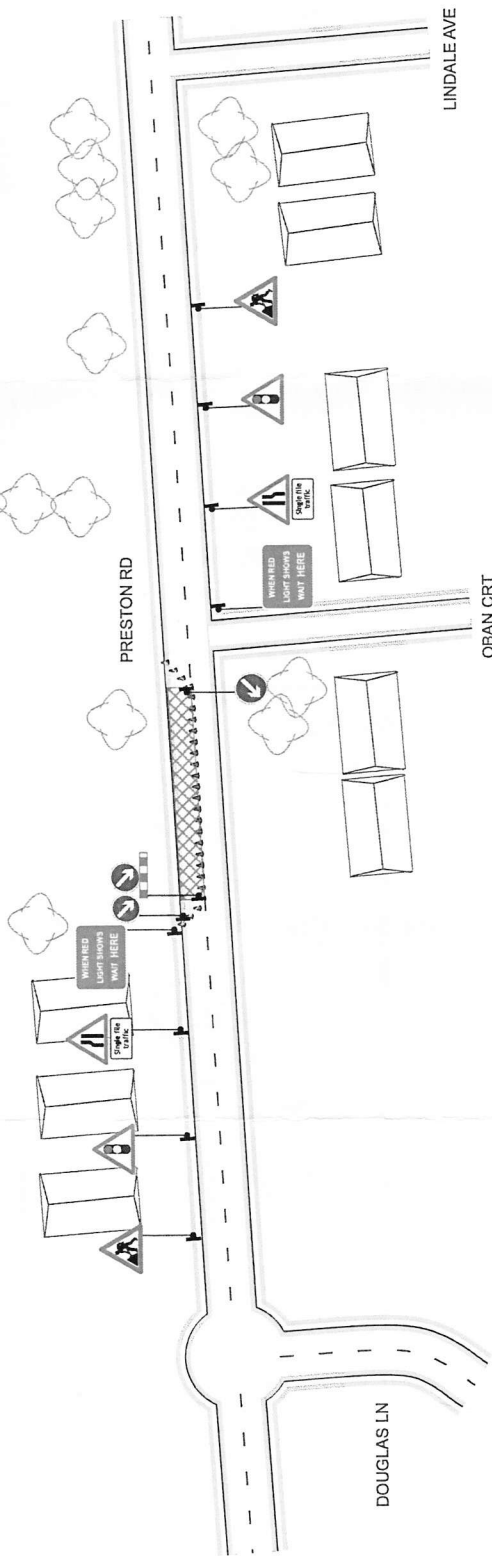
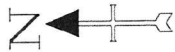

PHASE TWO

2 WAY LIGHTS TO BE MANNED
DAILY BETWEEN 0730 - 1800

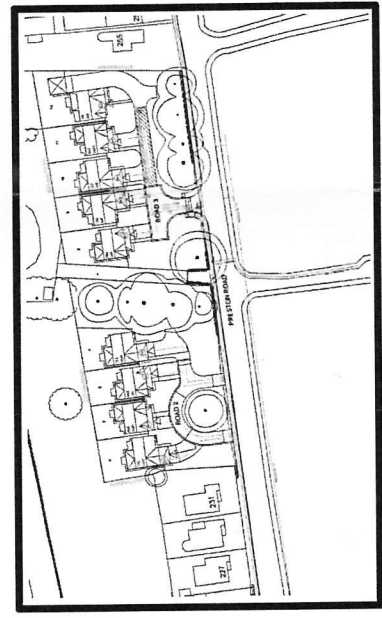

Key

- Signal Face
- Safety Zone
- Works Area

Signal Head	All Red	All Green
A	10 Sec	25 Sec
B	10 Sec	25 Sec

Please note that the setting of Maximum Green timer should be increased if substantial queues begin to form.

The timings should not be reduced below the initial settings approved.

Timings can be increased to suit traffic flow.

This drawing is the property of 2Works Ltd, it MUST NOT be copied in part or sent to a third party without written permission.

<p>2worksTM effective traffic management</p>	Client: Aptus Utilities Spen Trading Estate, Spen Lane, Cleckheaton, West Yorkshire, BD19 4AB Date: 05/07/2017 Tel: 0845 2221222	Drawing Description: 2 Way Lights Job Location: Preston Road, Grimsburgh	Drawing No: Drawn By: John Brierley Verified By: Philip Morris
	Client: Aptus Utilities Date: 05/07/2017 Not To Scale	Drawing Description: 2 Way Lights Job Location: Preston Road, Grimsburgh	Drawing No: Drawn By: John Brierley Verified By: Philip Morris



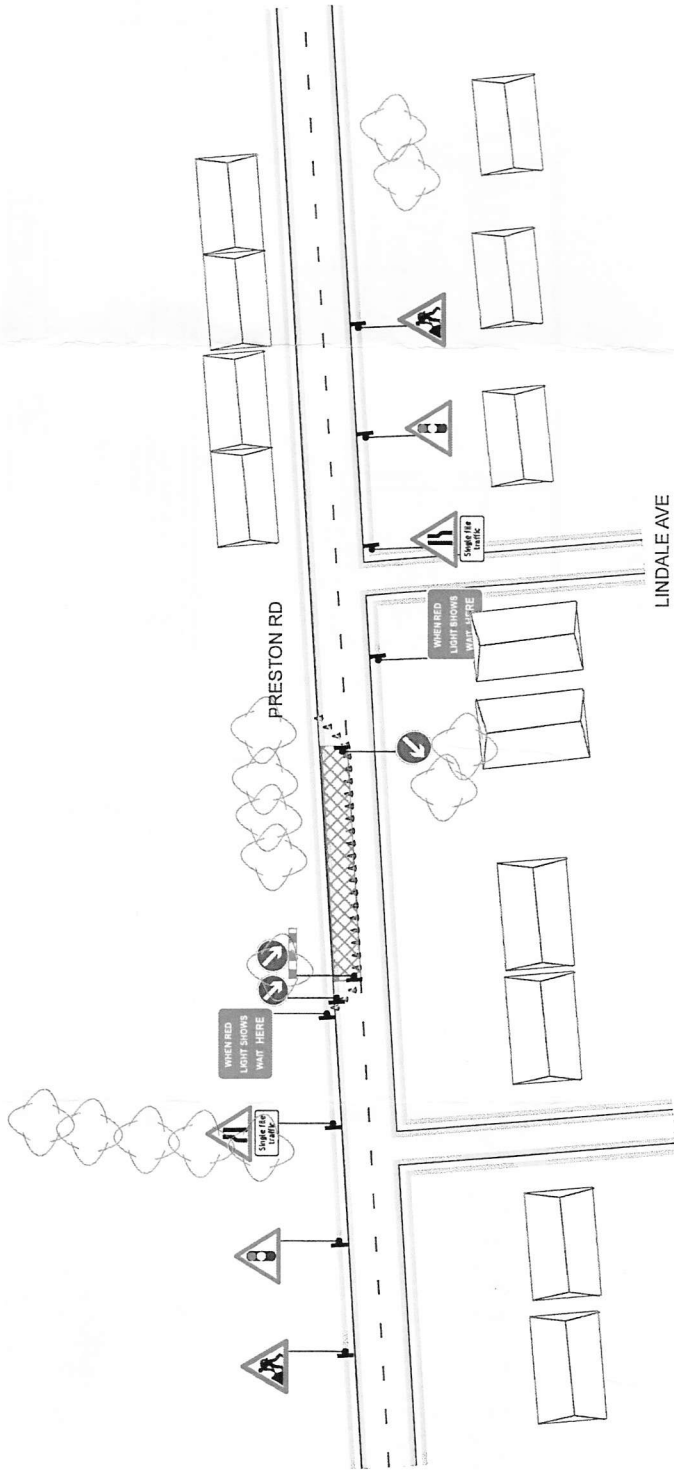
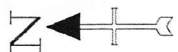

OBAN CRT

LINDALE AVE

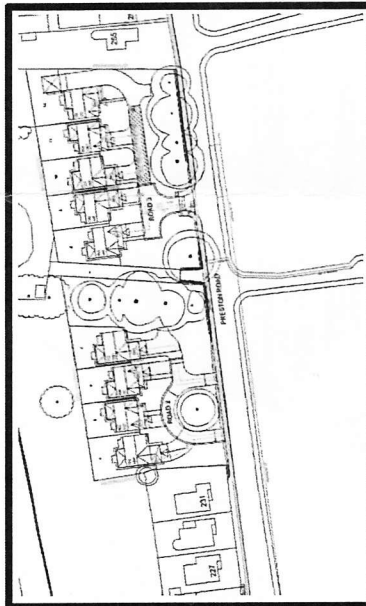

Key

- Sign Face
- Safety Zone
- Works Area

Signal Head	All Red	All Green
A	10 Sec	25 Sec
B	10 Sec	25 Sec

Please note that the setting of Maximum Green timer should be increased if substantial queues begin to form.

The timings should not be reduced below the initial settings approved.

Timings can be increased to suit traffic flow.

This drawing is the property of 2works Ltd. It MUST NOT be copied, in part or sent to a third party without written permission.

PHASE THREE

2 WAY LIGHTS TO BE MANNED
DAILY BETWEEN 0730 - 1800



Spenn Trading Estate,
Spenn Lane,
Cleckheaton,
West Yorkshire,
BD19 4AB

Tel:
0845 2221222

Client: Aplus Utilities



Date: 05/07/2017 Not To Scale

Drawing Description: 2 Way Lights

Job Location:
Preston Road, Grimsburgh

Comments:

Drawing No:

Drawn By:
John Brierley

Verified By:
Philip Morris



Accredited
Professional Engineer

