

HELP US look after WILDLIFE

Dogs are not allowed as they can disturb and harm wildlife. If you need to, you can walk your dog (on a short lead) along the public right of way. Assistance dogs are welcome.



Recycling bins are provided for your use in the car park and the Visitor Village.

WATCH OUT!

Take care near open water. Keep an eye on any children with you.

The reserve is prone to flooding at certain times of year. Please take note of any warning signs.

In winter the reserve road is gritted. Paths on the reserve and around the Visitor Village are untreated as rock salt harms wildlife and plants.

The following activities are not allowed on the reserve:

- Barbecues and fires
- Fishing
- Water sports
- Swimming

Thank you for visiting today!

THERE ARE A NUMBER OF WAYS YOU CAN CONTINUE TO SUPPORT OUR WORK

- Become a member
- Bring family and friends for Sunday lunch in our restaurant overlooking the lake
- Buy a special gift for someone in one of our shops
- Hold your business meeting, conference or special occasion in the UK's only floating Visitor Village
- Look out for events throughout the year from the Food Festival in June to open air theatre and family fun days.

JOIN LANCASHIRE WILDLIFE TRUST TODAY AND PARK FOR FREE*

Lancashire Wildlife Trust is dedicated to nature conservation and inspiring people about the natural world. Brockholes is a showcase of our work. Protecting our local wildlife and wild spaces is only possible with the support of our members. **If you care about wildlife please become a member today.**

(*Up to 5 hours - today only)



GET in TOUCH...

Got a question? You can get in touch here...

call us: 01772 872000

email us: info@brockholes.org

find out at www.brockholes.org



BROCKHOLES

hello there!

WELCOME TO THE HOME OF HAPPY HABITATS

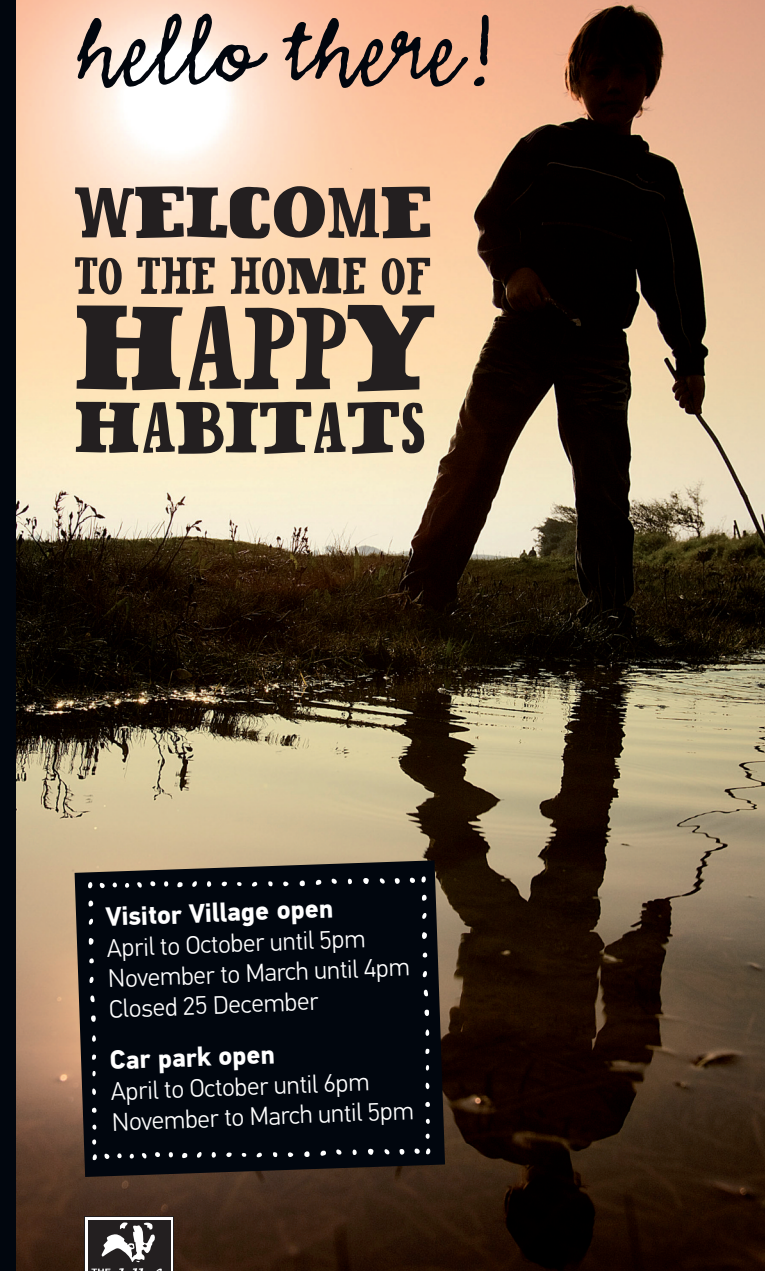

Visitor Village open

- April to October until 5pm
- November to March until 4pm
- Closed 25 December

Car park open

- April to October until 6pm
- November to March until 5pm



Lancashire, Manchester & N Merseyside

WWW.BROCKHOLES.ORG



FIND YOUR WAY AROUND

-  GRAVEL PIT TRAIL
-  MEADOW TRAIL
-  RESERVE TRAIL
-  TRAIL EXTENSION
-  PUBLIC FOOTPATH

WALKING TRAILS

Gravel Pit Trail 30 minutes walk

Meadow Lake Trail 1 hour walk

Reserve Trail 2 hour walk

The Gravel Pit and Reserve Trails are accessible for wheelchair users and pushchairs.

The Preston Guild Cycle Wheel follows the route of the public right of way.

FIND OUT MORE

Come to the Welcome Centre in the Visitor Village and find out why this place is so special. Guided walks of the reserve are available throughout the year.

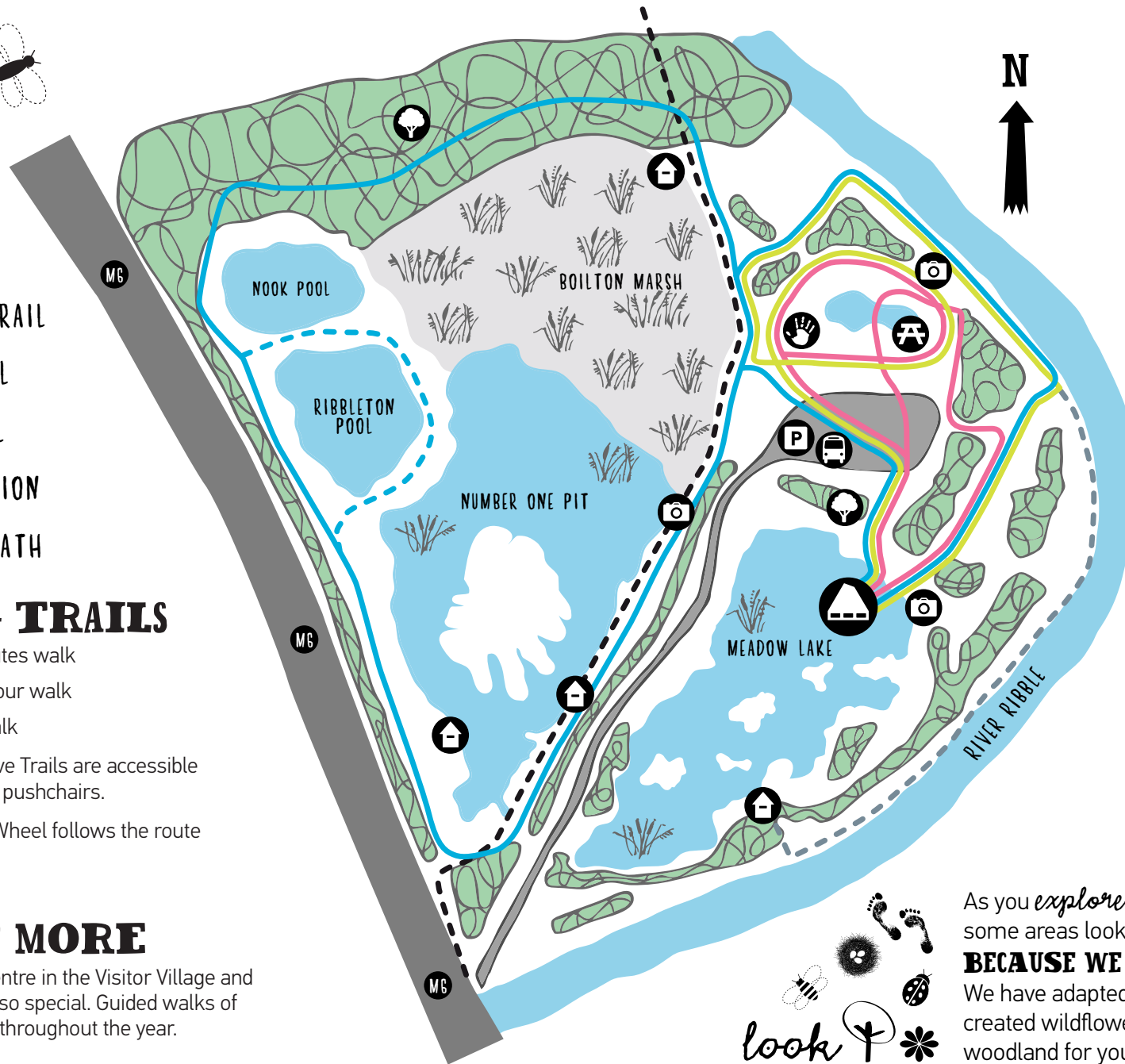

KEY

-  COACH PARK
-  HIDE
-  PARKING
-  PICNIC AREA
-  PLAY AREA
-  VIEWPOINT
-  WOODLAND
-  VISITOR VILLAGE
-  TOILETS
-  INFORMATION
-  RESTAURANT
-  GIFT SHOP
-  FOOD STORE
-  ACTIVITY ROOM
-  FIRST AID
-  BABY CHANGE
-  TRAILS START



As you *explore* the reserve you may notice some areas looking a little bare, why?

BECAUSE WE ARE STILL GROWING!
We have adapted the disused gravel pits and created wildflower meadows, reedbeds and woodland for you to **ENJOY.**

